

# Late Model Harley-Davidson Offset Mainshaft Sprockets



**Part No.  
284**

Available in 23 - 24T.



**Part No. 284**  
Total Offset  
Zero

Total offset of  
Zero. Uses  
full spline  
width of 0.766 in.

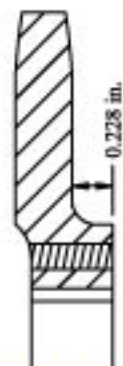

**Part No.  
277**

Available in 19 - 26T.

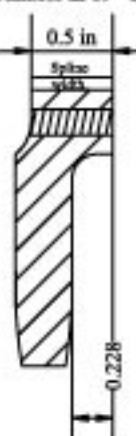

**Part No. 277**  
Total Offset  
0.228 in.

Sportster 5 spd  
stock sprocket.  
Uses lock screw  
for securing nut.

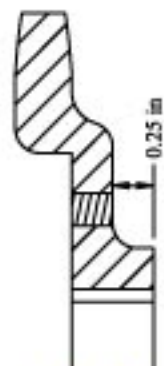

**Part No.  
280**

Available in 22 - 24T.

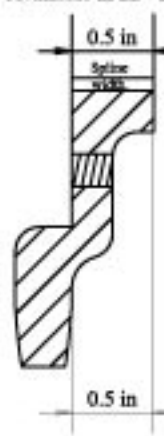

**Part No. 280**  
Total Offset  
0.500 in.

Late Model  
lock plate,ok.  
Spline width  
of 0.500 in.

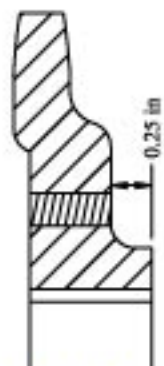

**Part No.  
283**

Available in 22 - 24T.

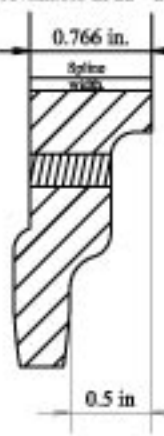

**Part No. 283**  
Total Offset  
0.500 in.

Late Model  
lock plate,ok.  
Spline width  
of 0.766 in.

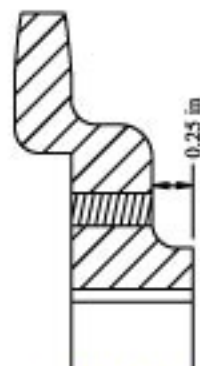

**Part No.  
281**

Available in 21 - 27T.

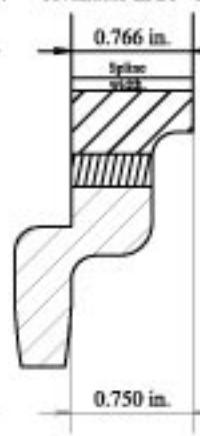

**Part No. 281**  
Total Offset  
0.750 in.

Late Model  
lock plate,ok.  
Spline width  
of 0.766 in.

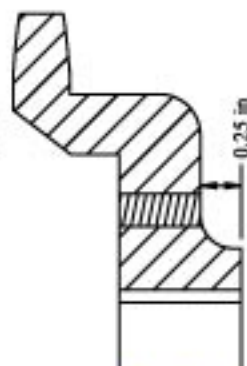

**Part No.  
288**

Available in 23 - 27T.

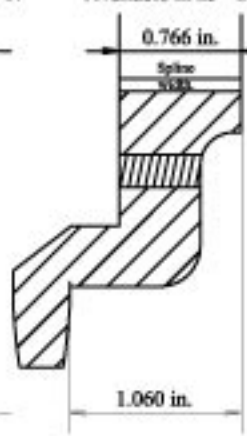

**Part No. 288**  
Total Offset  
1.060 in.

Late Model  
lock plate,ok.  
Spline width  
of 0.766 in.

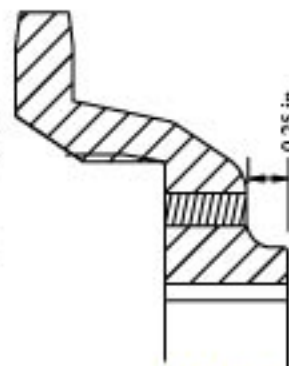

**Part No.  
289**

Available in 24T.

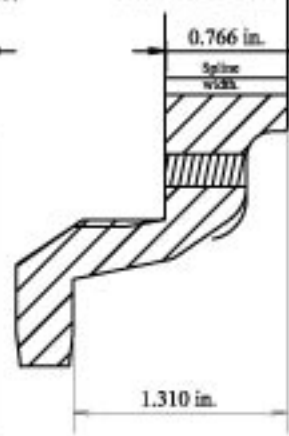

**Part No. 289**  
Total Offset  
1.310 in.

Late Model  
lock plate,ok.  
Spline width  
of 0.766 in.